

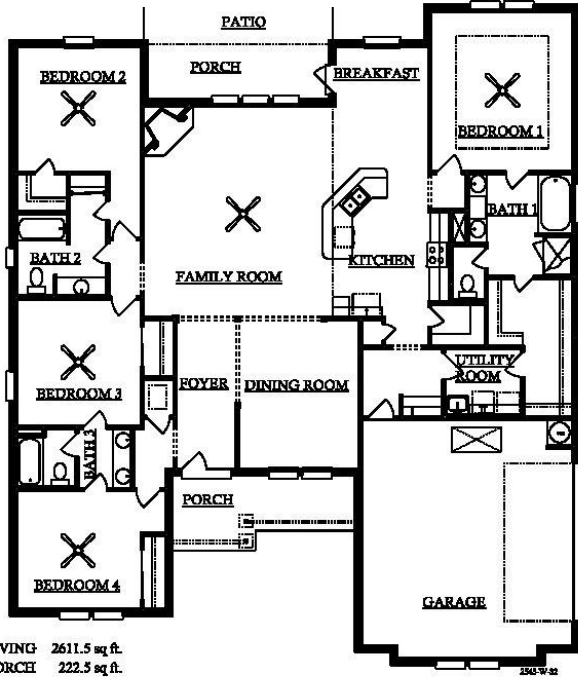

**THIS HOME IS LOCATED AT
9740 GWINNETT COURT W
(LOT#9, COLONIAL HILLS)**

6156 Omni Park Drive
Mobile, Al 36609
251.639.1155

**LIVINGSTON
4/3 G
SE**



LIVING 2611.5 sq. ft.
PORCH 222.5 sq. ft.
PATIO 123.0 sq. ft.
GARAGE 554.7 sq. ft.



Home Details

- \$231,900
- 3 Bedrooms
- 2 Full Baths | 1 Half Bath
- 2,201 Sq. Ft.

From the low maintenance brick exterior with dimensional shingles to the open and inviting floor plan with beautiful built cabinets, granite counter top, gracious pantry and stainless steel appliances in the kitchen.

This **CLAYTON II** plan features a split bedroom layout, with an open kitchen to the family room. Everyone gets to stay in all the activity while preparing the meal. This plan has that added plus of both a formal Dining Room and a Breakfast Room.

NOTE: 10 ft ceilings in the Family Room, 10 ft in the Dining Room and a gorgeous 10 ft tray ceiling in the Master Bedroom.

The Master Bath has the luxury of a separate tub and shower, 2 nice size walk-in closet, and double vanities. Plenty of room for everyone.

Covered entry porch and a covered porch and patio in the rear. Makes for plenty of outside entertaining or just watching the kids enjoy their backyard.

When it comes to new construction, the quality of craftsmanship found in a John Howard built home is unsurpassed. Builder's standard features include: [LP TechShield Radiant Heat Barrier](#) in attic, [Square D Electrical Panel](#) w/Surge Breaker, keyless entry [Schlage lock](#) system, [DSC security alarm](#), [2-10 Home Owner Warranty](#) and [Storm Tech Shutter Systems](#). Of course don't forget this John Howard Home is built as a silver level [FORTIFIED](#) home.

Elementary School: [Collier Elementary](#)

Middle School: [Causey Middle School](#)

High School: [Baker High School](#)

CONTACT US FOR MORE INFO:

**CALL TONYEA WEBER AT 251.300.3073/
251.639.1155**

**OR EMAIL TONYEA
TW@JOHNHOWARDHOMES.COM**

DIRECTIONS

- Off Airport Blvd just east of Snow Rd.
- 1/2 mile West of Baker High School.
- West on Airport Blvd. Before Snow Road
- Turn left onto Colonial Hills Dr.
- Left on Chambers Dr.
- Right on Colonial Crossings